

Pipe Support

Fix Points & Slides

6

Adjustable Angle Fittings

6a

p 6.003



RS

p 6.003



GHML

p 6.003



GHMR

Slide Guide Type S

6b

p 6.005



US

p 6.005



ES-1S

Slide Guide Type M

6c

p 6.006



ES-1M

p 6.006



ES-2M

p 6.006



ES-1MV

p 6.007



ES-2MV

p 6.007



ES-1MQ

p 6.007



ES-2MQ

Slide Guide Type H

6d

p 6.008



ES-1H

p 6.008



ES-1HV

p 6.008



ES-2H

p 6.009



ES-2HV

Slide Guide Type Quadro

6e

p 6.010



Quadro

Stainless Steel Slide Guide Type M

6f

p 6.011



ES-1M-SS

p 6.011



ES-2M-SS

p 6.012



ES-1MV-SS

p 6.012



ES-2MV-SS

Fix Point Herkules

6g

p 6.013



HERKULES
H

p 6.014



DIAGONAL
SHORE

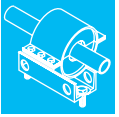

Pipe Support

Vertical Fix Point

p 6.015



VFP-KON

6h

Fix Point for Cooling pipes

p 6.016



GKSFP

p 6.017



GKSDUK

6i

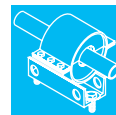

Adjustable Angle Fittings

Rod Swivel

Material : Steel DD11 - EN 10111

Finish : Electro zinc plated - EN ISO 12329

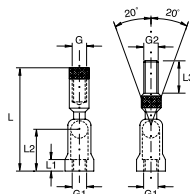

Art.Nr.	G	G1	G2	L mm	L1 mm	L2 mm	L3 mm	F1 kN	Kg /10C	
1240803	-	M8	M8	74	8	30	15	2.50	3.3	100
1241003	-	M10	M10	74	8	30	15	2.50	3.6	100
1241203	M12	M12	-	96	15	53	-	5.00	14.5	100
6642008	-	M8	M8	49	10	20	15	3.10	2.1	50
6642010	-	M10	M10	49	13	23	15	3.10	3.1	50

Adjustable Angle Fittings with sound insulation

Material : Steel DD11 - EN 10111

Finish : Electro zinc plated - EN ISO 12329

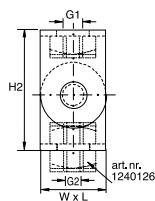

Art.Nr.	G	G1	L mm	W mm	H mm	Kg /10C	
1240086	M8	M8	25	36	45	11.4	100
1240106	M10	M10	25	36	45	11.2	100
1240126	M12	M12	25	36	64	12	100

Adjustable Angle Fittings with sound insulation

Material : Steel DD11 - EN 10111

Finish : Electro zinc plated - EN ISO 12329

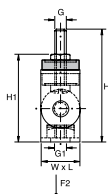

Art.Nr.	G	G1	L mm	W mm	H mm	H1 mm	H2 mm	F2 kN	Kg /10C	
1240886	M8	M8	25	36	70	60	45	5.7	13.1	100
1248106	M8	M10	25	36	70	60	45	5.7	13	100

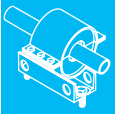

6.004

Adjustable Angle Fittings

6a

Slide Guides

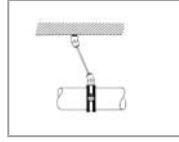
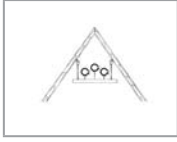

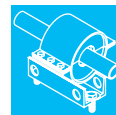

Slide Guide Type S

Slideblock for Unistrut channel

Material : Polyamid

Steel DD11 - EN 10111

Finish : Electro zinc plated - DIN EN 12329

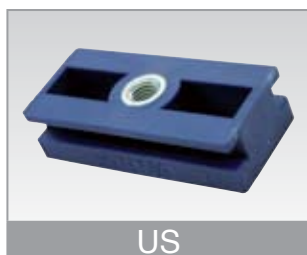

US

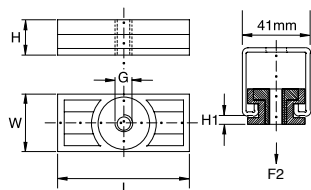

Art.Nr.	G	L	W	H	H1	F2	kg /10C	
		mm	mm	mm	mm	kN		
1241076	M10	80	35	21	4	3.0	6.8	10
1241276	M12	80	35	21	4	3.0	6.3	10

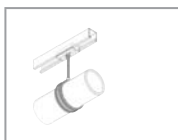

Slide Guide Type S

Material : Steel DD11 - EN 10111

Polyamide (PA) ; $\mu_0=0,18$ - $\mu=0,14$; $T_{max}=+120^{\circ}\text{C}$

Finish : Electro zinc plated - EN ISO 12329



ES-1S

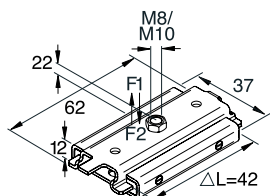

Art.Nr.	G	Delta L	F1	F2	kg /10C	
		mm	kN	kN		
1240810	M8/M10	42	0.7	0.7	8.2	50

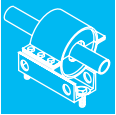

6.006

Slide Guide Type M

Slide Guide Type M

Material : Steel DD11 - EN 10111
Polyamide (PA) ; $\mu_0=0,18$ - $\mu=0,14$; $T_{max}=+120^\circ\text{C}$
Finish : Electro zinc plated - EN ISO 12329



ES-1M

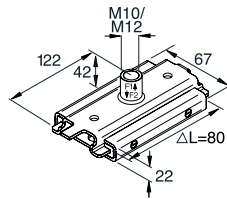

Art.Nr.	G	Delta L mm	F1 kN	F2 kN	$\frac{\text{Kg}}{100}$	
1241291	M10 / M12	80	2.3	2.3	40	10

Slide Guide Type M

Material : Steel DD11 - EN 10111
Polyamide (PA) ; $\mu_0=0,18$ - $\mu=0,14$; $T_{max}=+120^\circ\text{C}$
Finish : Electro zinc plated - EN ISO 12329



ES-2M

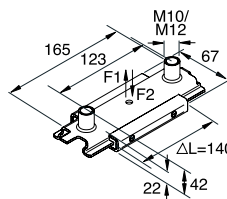

Art.Nr.	G	Delta L mm	F1 kN	F2 kN	$\frac{\text{Kg}}{100}$	
1241292	M10 / M12	140	2.3	2.3	48.8	10

Slide Guide Type M

Material : Steel DD11 - EN 10111
Polyamide (PA) ; $\mu_0=0,18$ - $\mu=0,14$; $T_{max}=+120^\circ\text{C}$
Finish : Electro zinc plated - EN ISO 12329



ES-1MV

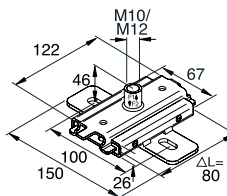

Art.Nr.	G	Delta L mm	F1 kN	F2 kN	$\frac{\text{Kg}}{100}$	
1241295	M10 / M12	80	2.3	2.3	60.2	10

6c

Slide Guides

TYCENSUP 06/09

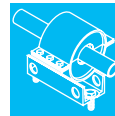

Slide Guide Type M

Slide Guide Type M

Material : Steel DD11 - EN 10111
Polyamide (PA) ; $\mu_0=0,18$ - $\mu=0,14$; $T_{max}=+120^{\circ}\text{C}$
Finish : Electro zinc plated - EN ISO 12329



ES-2MV

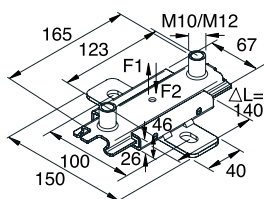

Art.Nr.	G	Delta L mm	F1 kN	F2 kN	Kg /100	
1241296	M10 / M12	140	2.3	2.3	68.7	10

Slide Guide Type M

Material : Steel DD11 - EN 10111
Polyamide (PA) ; $\mu_0=0,18$ - $\mu=0,14$; $T_{max}=+120^{\circ}\text{C}$
Finish : Electro zinc plated - EN ISO 12329



ES-1MQ

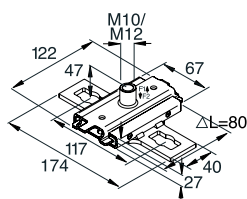

Art.Nr.	G	Delta L mm	F1 kN	F2 kN	Kg /100	
1241235	M10 / M12	80	2.3	2.3	60.2	10

Slide Guide Type M

Material : Steel DD11 - EN 10111
Polyamide (PA) ; $\mu_0=0,18$ - $\mu=0,14$; $T_{max}=+120^{\circ}\text{C}$
Finish : Electro zinc plated - EN ISO 12329



ES-2MQ

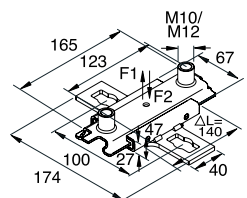

Art.Nr.	G	Delta L mm	F1 kN	F2 kN	Kg /100	
1241255	M10 / M12	140	2.3	2.3	72.4	10

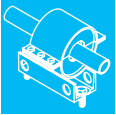

6.008

Slide Guide Type H

Slide Guide Type H

Material : Steel DD11 - EN 10111
Polyamphenylensulfid (PPS) ; $\mu_0=0,18$ - $\mu=0,14$; $T_{max}=+240^{\circ}\text{C}$
Finish : Electro zinc plated - EN ISO 12329

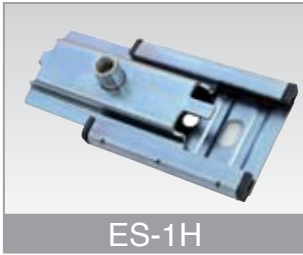

ES-1H

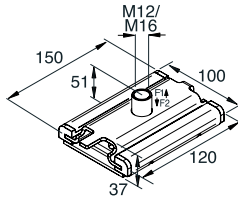

Art.Nr.	G	Delta L mm	F1 kN	F2 kN	$\frac{\text{Kg}}{100}$	
1241668	M12 / M16	120	9.0	5.0	40	10

Slide Guide Type H

Material : Steel DD11 - EN 10111
Polyamphenylensulfid (PPS) ; $\mu_0=0,18$ - $\mu=0,14$; $T_{max}=+240^{\circ}\text{C}$
Finish : Electro zinc plated - EN ISO 12329



ES-1HV

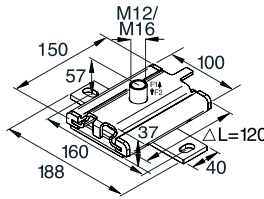

Art.Nr.	G	Delta L mm	F1 kN	F2 kN	$\frac{\text{Kg}}{100}$	
1241664	M12 / M16	120	9.0	5.0	40	10

Slide Guide Type H

Material : Steel DD11 - EN 10111
Polyamphenylensulfid (PPS) ; $\mu_0=0,18$ - $\mu=0,14$; $T_{max}=+240^{\circ}\text{C}$
Finish : Electro zinc plated - EN ISO 12329



ES-2H

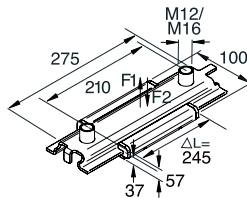

Art.Nr.	G	Delta L mm	F1 kN	F2 kN	$\frac{\text{Kg}}{100}$	
1241628	M12 / M16	245	9.0	5.0	40	10

6d

Slide Guides

TYCENSUP 06/09

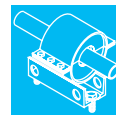

Slide Guide Type H

Slide Guide Type H

Material : Steel DD11 - EN 10111
 Polyamphenylensulfid (PPS) ; $\mu_0=0,18$ - $\mu=0,14$; $T_{max}=+240^{\circ}\text{C}$
 Finish : Electro zinc plated - EN ISO 12329



ES-2HV

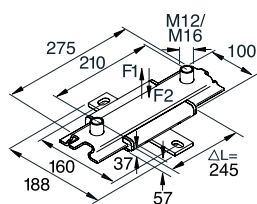

Art.Nr.	G	Delta L mm	F1 kN	F2 kN	$\frac{\text{Kg}}{100}$	
1241624	M12 / M16	245	9.0	5.0	40	10

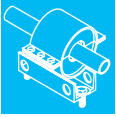

6.010

Slide Guide Type Quadro

2-Way Slide Guide Type Quadro

Material : Steel DD11- EN 10111

Polyamphenylensulfid (PPS); $\mu_0=0,18$ - $\mu=0,14$; $T_{max}=+240^\circ\text{C}$

Finish : Electro zinc plated - EN ISO 12329

6e

Slide Guides



Quadro

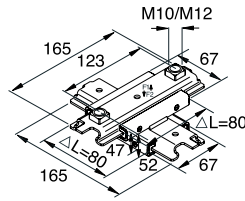

Art.Nr.	G	Delta L mm	F1 kN	F2 kN	$\frac{Q}{Kg}$ /100	
1240844	M8	80	2.3	2.3	10.0	5
1241044	M10	80	2.3	2.3	9.7	5
1241244	M12	80	2.3	2.3	9.8	5

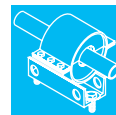

Stainless Steel Slide Guide Type M

Slide Guide Type M

Material : Stainless Steel - 1.4404 - EN 10088-2

Polyamide (PA) ; $\mu_0=0,18$ - $\mu=0,14$; $T_{max}=+120^{\circ}\text{C}$



ES-1M-SS

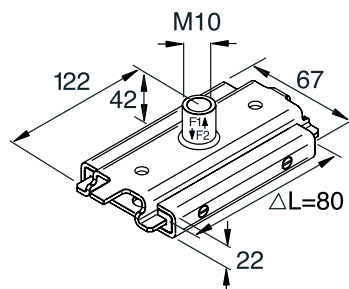

Art.Nr.	G	Delta L mm	F1 kN	F2 kN	$\frac{\text{kg}}{100}$	
1352401	M10	80	2.3	2.3	38.1	10

Slide Guide Type M Stainless Steel

Material : Stainless Steel - 1.4404 - EN 10088-2

Polyamide (PA) ; $\mu_0=0,18$ - $\mu=0,14$; $T_{max}=+120^{\circ}\text{C}$



ES-2M-SS

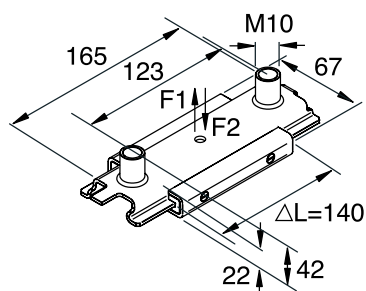

Art.Nr.	G	Delta L mm	F1 kN	F2 kN	$\frac{\text{kg}}{100}$	
1352405	M10	140	2.3	2.3	38.1	10

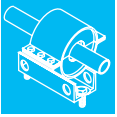

6.012

Stainless Steel Slide Guide Type M

Slide Guide Type M Stainless Steel

Material : Stainless Steel - 1.4404 - EN 10088-2
Polyamide (PA) ; $\mu_0=0,18$ - $\mu=0,14$; $T_{max}=+120^{\circ}\text{C}$

6f

Slide Guides



ES-1MV-SS

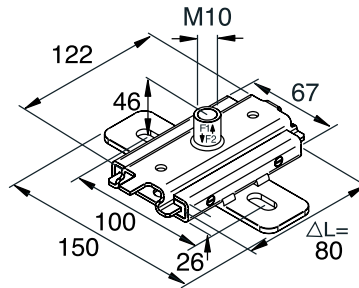

Art.Nr.	G	Delta L mm	F1 kN	F2 kN	kg /100	
1352402	M10	80	2.3	2.3	38.1	10

Slide Guide Type M Stainless Steel

Material : Stainless Steel - 1.4404 - EN 10088-2
Polyamide (PA) ; $\mu_0=0,18$ - $\mu=0,14$; $T_{max}=+120^{\circ}\text{C}$



ES-2MV-SS

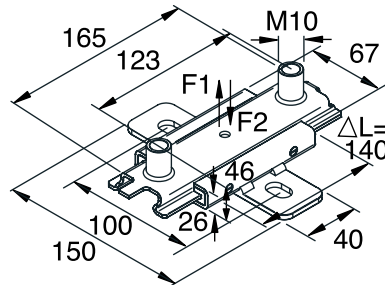

Art.Nr.	G	Delta L mm	F1 kN	F2 kN	kg /100	
1352406	M10	140	2.3	2.3	38.1	10

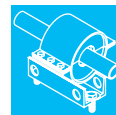

Fix Point Herkules

Fix Point Herkules

Material : Steel DD11 - EN 10111

EPDM/SBR black; SHORE A = 45 ϕ $\bar{n}5\phi$

Finish : Electro zinc plated - EN ISO 12329 + Spannring vernickelt - EN 12540



HERKULES H

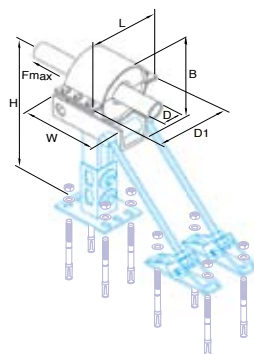
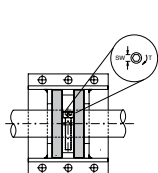

Sound insulation tested

6g

Fix Points

Art.Nr.	D Inch	D mm	D1 mm	L mm	W mm	H mm	H1 mm	F5 kN	Tinst Nm	Suitable for:	pcs.	SW	Kg /100	
1501151	-	15	74	120	140	200-1000	115	3	15	FAZ10/10 FAZ12/10	4+1	5	151.4	5
1501181	3/8	18	74	120	140	200-1000	115	3	15	FAZ10/10 FAZ12/10	4+1	5	150.4	5
1501221	1/2	22	74	120	140	200-1000	115	3	15	FAZ10/10-FAZ12/10	4+1	5	235.3	5
1501281	3/4	28	74	120	140	200-1000	115	3	15	FAZ10/10-FAZ12/10	4+1	5	230.9	5
1501352	1	35	92	140	140	200-1000	135	5	15	FAZ10/10-FAZ16/10	4+1	5	178.7	5
1501422	1 1/4	42	92	140	140	200-1000	135	5	15	FAZ10/10-FAZ12/10	4+1	5	366.0	5
1501483	1 1/2	48	125	175	160	200-1000	170	10	30	FAZ10/10-FAZ16/10	4+2	6	446.0	1
1501543	-	54	125	175	160	200-1000	170	10	30	FAZ10/10-FAZ16/10	4+2	6	363.9	1
1501573	-	57	125	175	160	200-1000	170	10	30	FAZ10/10-FAZ16/10	4+2	6	356.8	1
1501603	2	60	125	175	160	200-1000	170	10	30	FAZ10/10-FAZ16/10	4+2	6	467.0	1
1501764	2 1/2	76	150	205	180	200-1000	190	15	30	FAZ10/10-FAZ16/20	4+4	6	635.0	1
1501894	3	89	150	205	180	200-1000	190	15	30	FAZ10/10-FAZ16/20	4+4	6	490.9	1
1501145	4	114	205	280	200	200-1000	260	20	60	FAZ10/10-FAZ20/30	4+4	8	951.2	1
1501405	5	140	205	280	200	200-1000	260	20	60	FAZ10/10-FAZ20/30	4+4	8	600.0	1
1501686	6	168	275	355	200	310-1000	318	30	-	FAZ10/10-FAZ20/60	4+8	-	172.4	1
1501197	8	219	324	404	200	330-1000	369	30	-	FAZ10/10-FAZ20/60	4+8	-	224.0	1
1501738	10	273	407	487	200	370-1000	454	30	-	FAZ10/10-FAZ20/60	4+8	-	334.0	1

Art.Nr.	D Inch	D mm	D1 mm	L mm	W mm	H mm	H1 mm	F5 kN	Tinst Nm	Range °C	Suitable for:	pcs.	SW	Kg /100	
1502151	-	15	74	120	140	200-1000	115	3	15	<+220	FAZ10/10 FAZ12/10	4+1	5	151.4	5
1502181	3/8	18	74	120	140	200-1000	115	3	15	<+220	FAZ10/10 FAZ12/10	4+1	5	150.4	5
1502221	1/2	22	74	120	140	200-1000	115	3	15	<+220	FAZ10/10-FAZ12/10	4+1	5	235.3	5
1502281	3/4	28	74	120	140	200-1000	115	3	15	<+220	FAZ10/10-FAZ12/10	4+1	5	230.9	5
1502352	1	35	92	140	140	200-1000	135	5	15	<+220	FAZ10/10-FAZ16/10	4+1	5	178.7	5
1502422	1 1/4	42	92	140	140	200-1000	135	5	15	<+220	FAZ10/10-FAZ12/10	4+1	5	366.0	5
1502483	1 1/2	48	125	175	160	200-1000	170	10	30	<+220	FAZ10/10-FAZ16/10	4+2	6	446.0	1
1502543	-	54	125	175	160	200-1000	170	10	30	<+220	FAZ10/10-FAZ16/10	4+2	6	363.9	1
1502573	-	57	125	175	160	200-1000	170	10	30	<+220	FAZ10/10-FAZ16/10	4+2	6	356.8	1
1502603	2	60	125	175	160	200-1000	170	10	30	<+220	FAZ10/10-FAZ16/10	4+2	6	467.0	1
1502764	2 1/2	76	150	205	180	200-1000	190	15	30	<+220	FAZ10/10-FAZ16/20	4+4	6	635.0	1
1502894	3	89	150	205	180	200-1000	190	15	30	<+220	FAZ10/10-FAZ16/20	4+4	6	490.9	1
1502145	4	114	205	280	200	200-1000	260	20	60	<+220	FAZ10/10-FAZ20/30	4+4	8	951.2	1
1502405	5	140	205	280	200	200-1000	260	20	60	<+220	FAZ10/10-FAZ20/30	4+4	8	600.0	1
1502686	6	168	275	355	200	310-1000	318	30	-	<+220	FAZ10/10-FAZ20/60	4+8	-	159.0	1
1502197	8	219	324	404	200	330-1000	369	30	-	<+220	FAZ10/10-FAZ20/60	4+8	-	220.0	1
1502738	10	273	407	487	200	370-1000	454	30	-	<+220	FAZ10/10-FAZ20/60	4+8	-	321.0	1



6.014

Fix Point Herkules

Diagonal Shore for Fix Point Herkules

Material : Steel DD11 - EN 10111



Finish : Electro zinc plated - EN ISO 12329

6g

Fix Points



DIAGONAL SHORE

Art.Nr.	D mm	D1 mm	D2 mm	G	L mm	L1 mm	Suitable for:	 Kg /100	
1502001	20	13	13	M12	50	1000	15-42mm	129.5	1
1502002	25	17	17	M16	80	1000	48-60mm	230.3	1
1502003	25	17	14	M16	150	1000	76-84mm	281.9	1
1502004	25	22	22	M16	170	1000	114-140mm	299.0	1
1502005	-	-	22	22	-	1000	168-273mm	1081.6	1

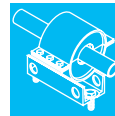

Vertical Fix Point

Vertical Fix Point

Material : Steel DD11 - EN 10111

Finish : Electro zinc plated - EN ISO 12329



VFP-KON

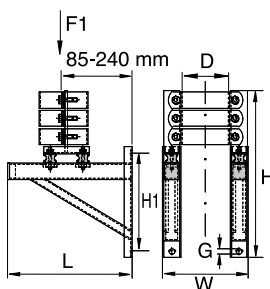

Art.Nr.	D Inch	G	L mm	W mm	H mm	H1 mm	F1 kN	kg/100	
1300521	2 1/2	13	210	185	395	158	10.000	574.6	1
1300523	2 1/2	13	310	175	420	240	8.000	541.2	1
1300531	3	13	210	195	395	158	10.000	595.2	1
1300533	3	13	310	190	420	240	8.000	562	1
1300541	4	13	210	215	395	158	10.000	618	1
1300543	4	13	310	210	420	240	8.000	584.2	1



6.016

Fix Point for Cooling pipes



Fix Point For cooling pipes

Material : Steel DD11 - EN 10111
 Polyurethane 250 kg/m; W=0.041w/Mk; æ=2500
 Finish : Electro zinc plated - EN ISO 12329

6i

Fix Points



Art.Nr.	DN	W mm	T mm	F1 kN	 /100	
GKSFP07630	65	10	30	1.9	1900.0	1
GKSFP08930	80	10	30	2.1	2100.0	1
GKSFP11440	100	10	40	3.0	3100.0	1
GKSFP13340	125	10	40	3.6	3700.0	1
GKSFP13940	125	15	40	4.9	500.0	1
GKSFP15940	150	15	40	5.1	520.0	1
GKSFP16840	150	15	40	5.6	570.0	1
GKSFP21960	200	15	60	9.3	950.0	1
GKSFP27360	250	20	60	12.8	1310.0	1
GKSFP32460	300	20	60	14.6	1490.0	1
GKSFP36860	350	20	60	16.8	1710.0	1
GKSFP40660	400	20	60	18.0	1830.0	1
GKSFP45760	450	20	60	19.5	1980.0	1
GKSFP50860	500	20	60	21.7	2210.0	1
GKSFP60960	600	20	60	25.4	2590.0	1

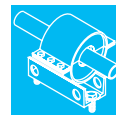

Fix Point for Cooling pipes

Fix Point for cooling pipes

Material : Steel DD11 - EN 10111

Finish : Electro zinc plated - EN ISO 12329



GKSDUK

Art.Nr.	DN	W mm	WEIGHT Kg	
GKSDUK114			1.90	1
GKSDUK133	125	120	2.0	1
GKSDUK139	125	120	2.0	1
GKSDUK159	150	120	2.30	1
GKSDUK168	150	120	2.30	1
GKSDUK219	200	200	5.94	1
GKSDUK273	250	200	6.80	1
GKSDUK324	300	200	8.76	1
GKSDUK368	350	200	9.26	1
GKSDUK406	400	240	12.40	1
GKSDUK457	450	240	13.56	1
GKSDUK508	500	240	14.74	1
GKSDUK609	600	240	17.01	1