



Fixings

Beam, roof & purlin fixings

9

Fixings onto steel beams

9a

p 9.002	p 9.002	p 9.003	p 9.004	p 9.004	p 9.005	p 9.005
UBC	91	Strap	FLS	Strap-FLS	LC	P

Fixings onto steel roofs & purlins

9b

p 9.006	p 9.006	p 9.006	p 9.007	p 9.007	p 9.008	p 9.008	p 9.008
TCB	TCAB	TCABNR	PERFO	TD	DSTR-1	TEK50	SWDR-1
p 9.009	p 9.009	p 9.010	p 9.010				
XP20	XP-IT	VN	Z				



9.002

Fixings onto steel beams

Beam clamp

Material : Malleable Iron - EN 1562-1997
 Finish : Electro zinc plated - EN ISO 12329

9a
 Beam, roof & purlin fixings



UBC

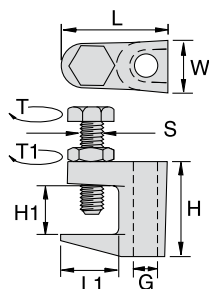

✓ ISO 9001
 ✓ approved products



Art.Nr.	G	L mm	L1 mm	W mm	H mm	H1 mm	S	F1 kN	Tinst Nm	T1 Nm	FM	VdS	kg /100	
UBC6T	M6	36	20	19	35	17	M8	1.1	8	11			16.5	50
UBC8D	9	36	20	19	35	17	M8	1.1	8	11		x	16.5	50
UBC8T	M8	36	20	19	35	17	M8	1.1	8	11		x	16.5	50
UBC10D	11	45	22	22	40	19	M10	2.4	8	22	x	x	16.5	50
UBC10T	M10	45	22	22	40	19	M10	2.4	8	22	x	x	16.5	50
UBC12D	13	50	28	25	46	23	M10	3.1	8	22	x	x	16.5	25
UBC12T	M12	50	28	25	46	23	M10	3.1	8	22	x	x	16.5	25
90M162	M16	51	26	25	39	19	M12	5.3	8	22		x	16.5	50



Beam clamp

Material : Malleable Iron - EN 1562-1997



91

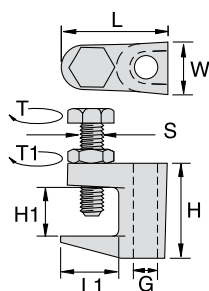

✓ ISO 9001
 ✓ approved products



Art.Nr.	G	L mm	L1 mm	W mm	H mm	H1 mm	S	F2 kN	FM	VdS	kg /100	
91M102	M10	45	26	19	51	33	M10	2.600	Y	Y	22.4	50
91M112	11	45	26	19	51	33	M10	2.600	Y	Y	22.4	50
91M122	M12	49	27	28	60	33	M12	4.400	Y	Y	38	50
91M132	13	49	27	28	60	33	M12	4.400	Y	Y	38	50

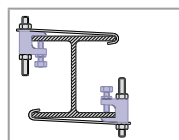
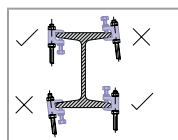
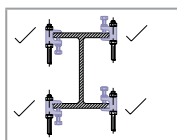

TYCENSUP 06/09



Fixings onto steel beams

Retaining strap

Material : Steel DX51D+Z275 - EN 10327

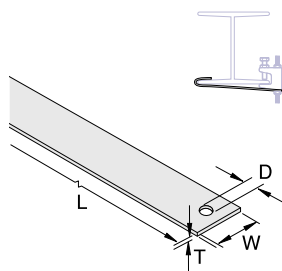

Art.Nr.	D mm	L mm	W mm	T mm	kg /100	
STRAPM10	11	300	21	2.5	11.8	100
STRAPM12	13	300	30	2.5	17.7	100
STRAPM16	17	300	40	3.0	28.3	100



9.004

Fixings onto steel beams

Articulated beam clamp

Material : Steel DD11 - EN 10111; Stainless Steel

9a

Beam, roof & purlin fixings



FLS

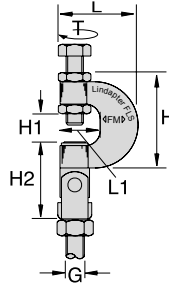

✓ ISO 9001
✓ approved products



Art.Nr.	G	L	L1	H	H1	H2	F2	F5	Tinst	FM	VdS	kg/100
		mm	mm	mm	mm	mm	kN	kN	Nm			
FLS08	M8	53	27	58	17	55	2.500	1.500	18		Y	20
FLS10	M10	53	27	58	17	55	2.500	1.500	18	Y	Y	29
FLS104	M10	53	27	58	17	55	2.500	1.500	18	Y	Y	29

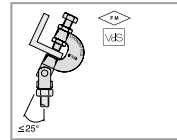
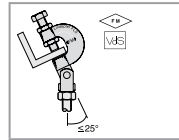
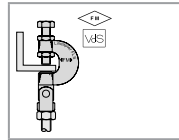
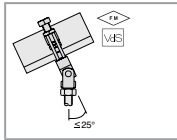

Material : Steel DD11 - EN 10111
Finish : Electro zinc plated - DIN EN 12329



Strap-FLS

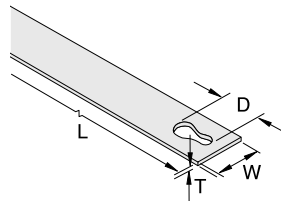

Art.Nr.	D	L	W	T	kg/100	
	mm	mm	mm	mm		
STRAPFLS						



Fixings onto steel beams

Light duty beamclamp

Material : Steel DD11 - EN 10111



LC

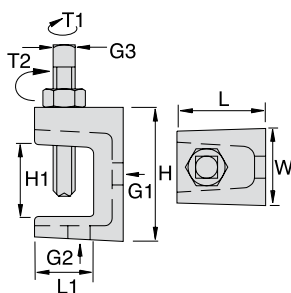

9a

Beam, roof & purlin fixings

Art.Nr.	G	G1	G2	L	L1	H	H1	F3	F4	Tinst	kg/100	
				mm	mm	mm	mm	kN	kN	Nm		
LCLIP	M6	M6	M6	24	16	35	20	0.590	0.180	4	6.4	100



Beam clamp for 41mm width channel

Material : Cast iron - GGG-40

Finish : Electro zinc plated - DIN EN 12329



P

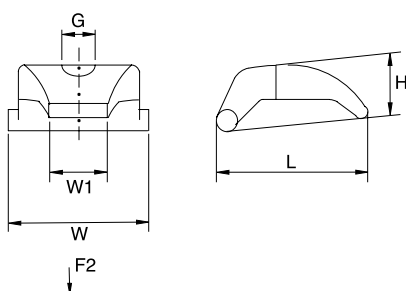

Art.Nr.	G	L	W	W1	H	T	F2	kg/100	
		mm	mm	mm	mm	mm	kN		
1391075	10.5	48.5	43.5	16	20	1.0-25.0	4.5	10	10
1391275	12.5	65.5	51.5	20	27	1.0-35.0	8	25	10
1391675	17	65	63	24	32	1.0-35.0	9	46	10



9.006

Fixings onto steel roofs & purlins

Trapeze ceiling fixing

Material : Steel DD11 - EN 10111

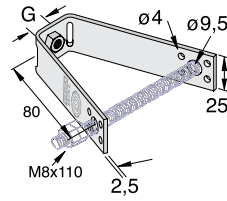

✓ ISO 9001
✓ approved products



9b

Beam, roof & purlin fixings

Art.Nr.	G	FM	VdS	kg /100	
1460408	M8 HR	-	-	11.6	100
1460410	M10 HR	-	-	11.5	100
TCB10	M10	Y	Y	10	100
TCB8	M8	-	Y	10.9	100
TCBN12	13	-	-	10	100

Trapeze ceiling fixing

Material : Steel DX51D+Z275 - EN 10327

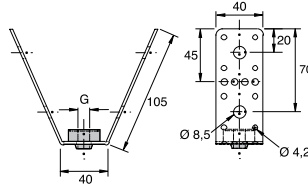

Art.Nr.	G	F2 kN	kg /100	
1460308	8.5	2.0	14.8	100
1460310	10.5	2.0	14.6	100

Trapeze ceiling fixing

Material : Steel DX51D+Z275 - EN 10327

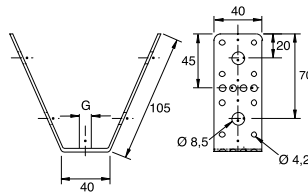

Art.Nr.	G	F2 kN	kg /100	
1460510	10.5	2.0	7.6	100

TYCENSUP 06/09



Fixings onto steel roofs & purlins

Trapeze ceiling fixing tool

Material : Steel DD11 - EN 10111



PERFO

Art.Nr.	L mm	Kg /100	
2210088	700	247	1
2210089		9	2

Tipping dowel for hollow ceilings

Material : Steel DX51D+Z275 - EN 10327



TD

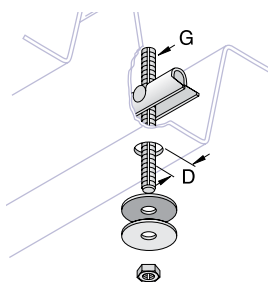

✓ ISO 9001
✓ approved products



Art.Nr.	D mm	G	F2 kN	FM	VdS	Kg /100	
1740065	15	M6x85	0.8			4.8	100
TDM10X100	25	M10x100	0.8	Y	Y	18	50
TDM10X200	25	M10x200	0.8	Y	Y	18	50
TDM8X100	22	M8x100	0.8		Y	18	100
TDM8X200	22	M8x200	0.8		Y	18	100
TDM8X300	22	M8x300	0.8		Y	18	50
TDM8X500	22	M8x500	0.8		Y	18	50

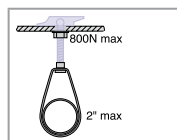
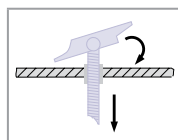
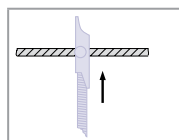
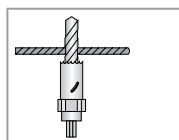



9.008

Fixings onto steel roofs & purlins

Sammy M10 vertical for steel roofs with nut

Material : Carbon Steel
Finish : Electro Zinc



DSTR-1

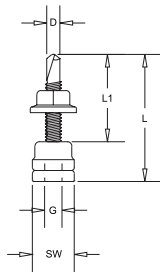

Art.Nr.	G	L mm	L1 mm	SW	FM	kg /100	
8159957	M10	52	37	16	x	2.5	125

Sammy M10 vertical for steel roofs

Material : Carbon Steel
Finish : Electro Zinc



TEK50

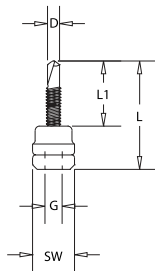

Art.Nr.	G	L mm	L1 mm	SW	FM	kg /100	
8176957	M10	40	25.4	16	x	2.8	125

Sammy M10 horizontal steel with nut

Material : Carbon Steel
Finish : Electro Zinc



SWDR-1

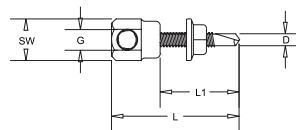

Art.Nr.	G	L mm	L1 mm	SW	FM	kg /100	
8161957	M10	45	25.4	16	x	3.3	125

9b

Beam, roof & purlin fixings

TYCENSUP 06/09



Fixings onto steel roofs & purlins

Sammy X-press M10 for steel roofs

Material : Carbon Steel

Finish : Electro Zinc



XP20

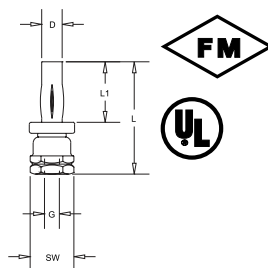

Art.Nr.	G	L	L1	do	SW	FM	Kg /100	
		mm	mm	mm				
8188957	M10	47	25	10	16	x	3.8	125

Sammy X-press installation Tool

Material : Carbon Steel

Finish : Electro Zinc



XP-IT

Art.Nr.	Kg /100	
8151910	10	5



9.010

Fixings onto steel roofs & purlins

V Nut

Material : Steel DD11 - EN 10111

9b

Beam, roof & purlin fixings

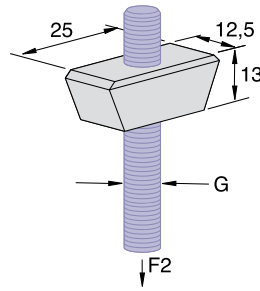
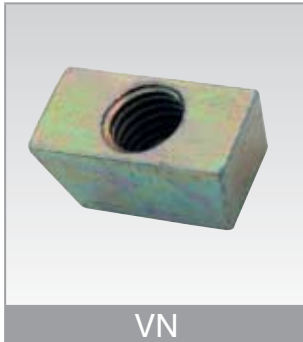

Art.Nr.	G	F2 kN	kg /100	
VN08	M8	2.000	1.9	500
VN10	M10	2.100	1.8	500

Z Purlin clamp

Material : Steel DX51D+Z275 - EN 10327

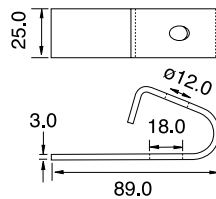

Art.Nr.	kg /100	
Z10U	6.4	100

